

PLCC 6 Package SMD LED

Description

The constructive of this series of LEDs are different from the PCB type SMT LED. The lead-frame is of metal, reflector is made of thermoplastic and construct into this unique type of SMD LED. The Wavelengths and Luminous Intensities of this series are grouped under 20mA for uniformity.

VR K6A85

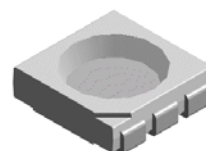

Applications

- Dashboards and switch
- Backlight keypads
- Industrial control systems signal indicator
- Automotive features
- Telephone and fax backlighting or indicator

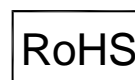

Electronic Optical Characteristics (at 20mA per chip condition):

Part Number	Emitted Color	λ (nm)		Lens Color	Iv(mcd)		View Angle (2 θ 1/2)	VF(V)	
		λ d	λ p		Min.	Max.		Typ.	Max.
VR K6A85	Yellow 	589	591	Clear	1500	2000	120	2.2	2.4

Absolute Maximum Ratings (at Ta=25°C)

P _D (mW)	I _{FP} (mA)	I _F (mA)	Soldering Temp.(°C)	I _R (uA)@V _R =5V	Topr(°C)	Tstg(°C)
200	100*	60	260 ± 5 for 5 sec.	10	-40~+85	-40~+100

Note: Please take note the Absolute Maximum Rating values. Any operation beyond the specify ratings in this table will result degradation of LED life-span and may cause LED to fail.

* I_{FP}: Peak Forward Current under 1/10 duty, 1KHz condition

* Above rating base on one dice condition

Package Dimension:

unit:mm

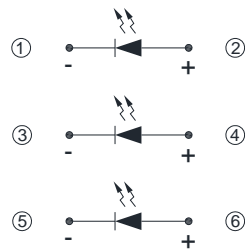

Polarity

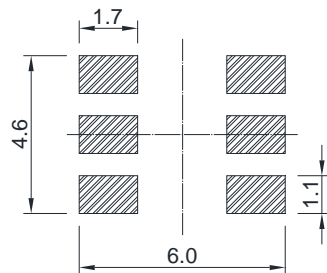
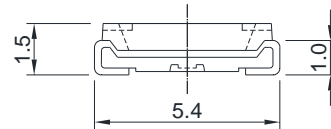
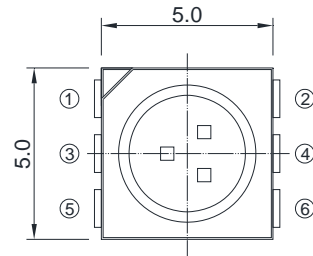

Recommended Soldering Pad

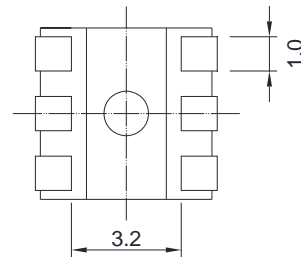

Notes:

1. All dimensions are millimeters.
2. Tolerance is $\pm 0.2\text{mm}$ unless otherwise specified.
3. Specifications are subject to change without notice.

Optical Characteristics Curves

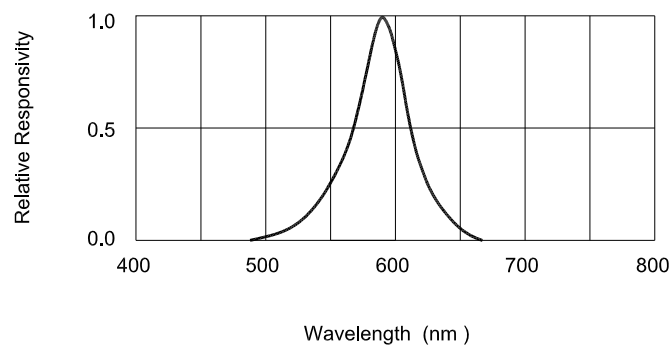
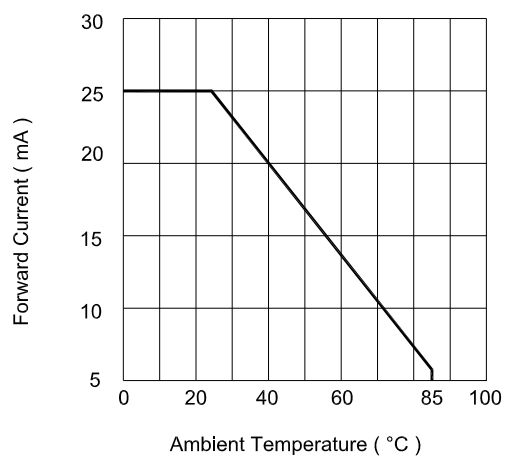
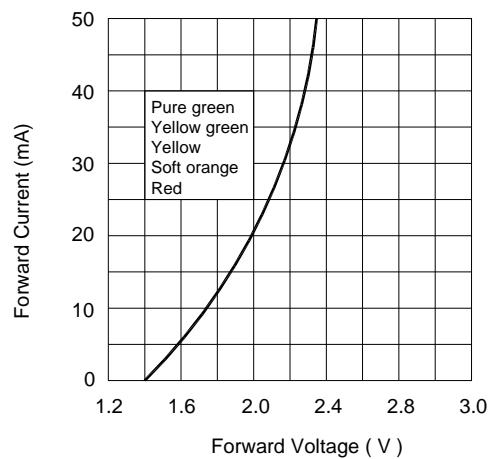
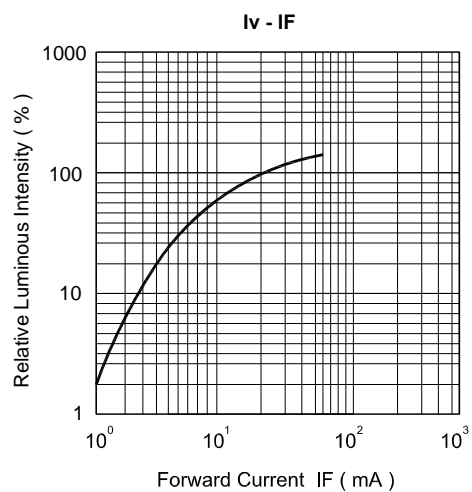
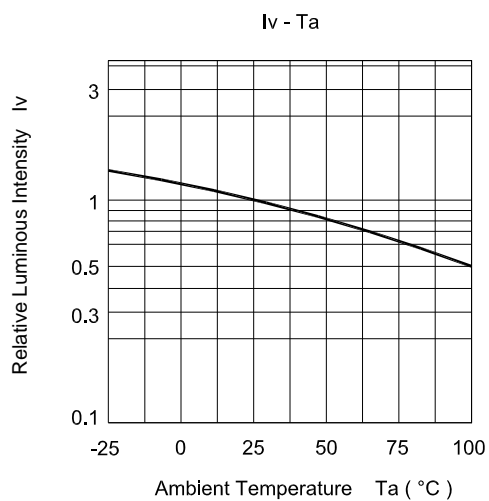

Reel Dimension:

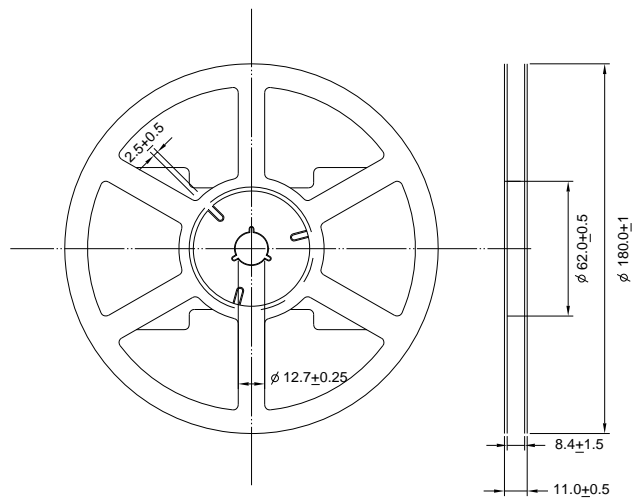

Note:

Available in 8mm carrier tape on 178mm diameter reels. (1,000 pieces)

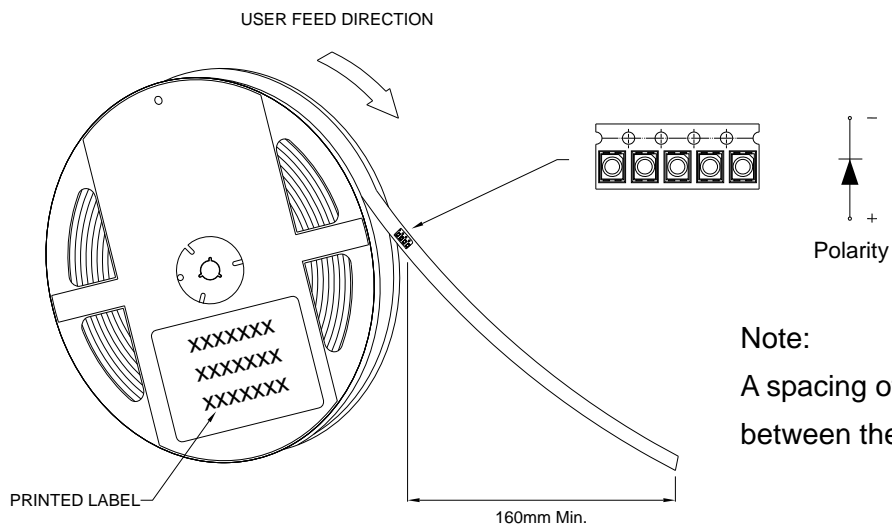

Note:

A spacing of approximately 160mm between the front edge of tape

Tape Dimension:

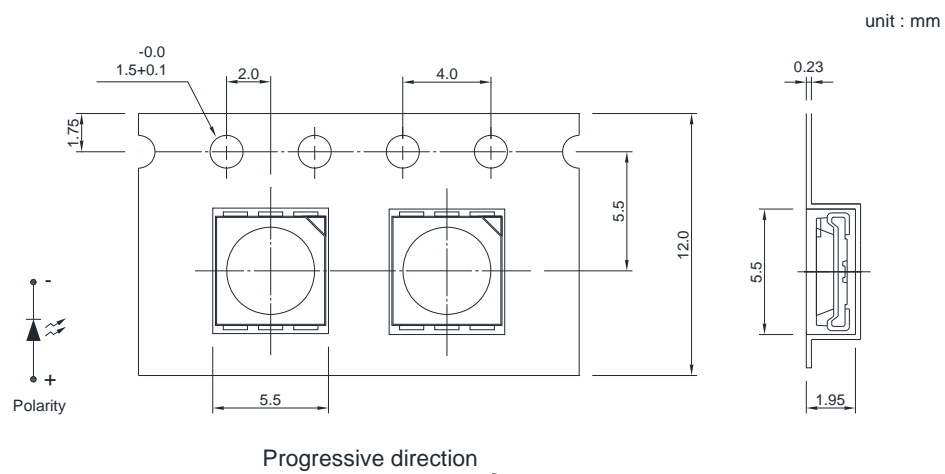

Recommended re-flow soldering profile:

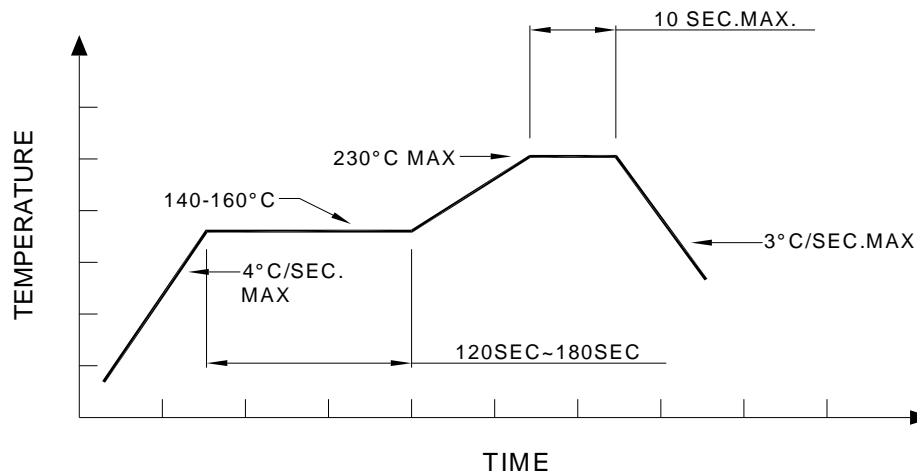

Recommended Pb-free re-flow soldering profile:

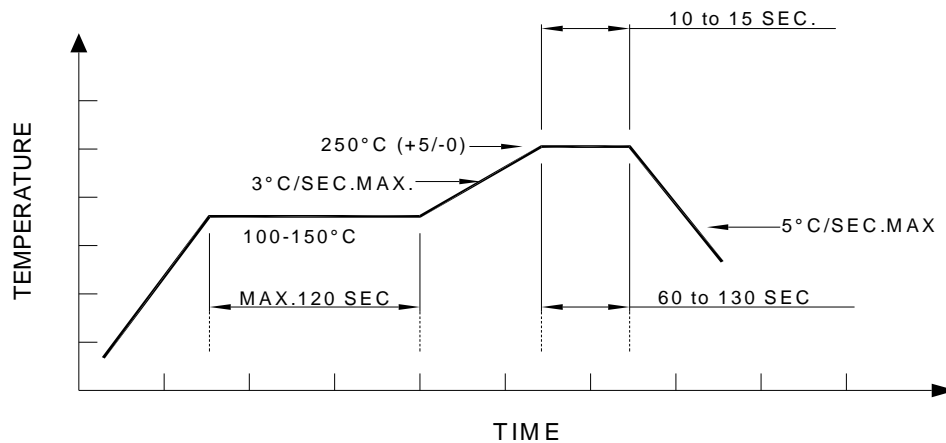

Note:

All the specifications listed in this data sheet are suitable for general electronic equipment, office equipment and communication devices. Kindly consult Sales Representatives for specific reliabilities request, Forward Voltage, Luminous Intensity, Wavelength, Radiant Power or Viewing Angle.