

Super Flux LED 80 Degree View Angle

VT 6668

Description

The series of LEDs is known as 'Super Flux' LED, able to withstand high drive current application. With special design Lead-Frame, the heat dissipation capability is increased. During high operating forward current, the luminous intensity is increase tremendously. As such, the overall cost is reduced with less number of LEDs being used. These LED can be used as traffic single light, signal board or in full color applications.

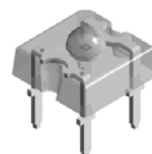

Features

- High luminous flux output
- Supreme heat dissipation
- Package in tubes for automatic insertion
- Luminous and color categorized for each tube
- RoHS compliance



Electronic Optical Characteristics (at 70mA):

Part Number	Emitted Color	λ (nm)		Lens Color	Flux(mlm)		View Angle (2 θ 1/2)	VF(V)	
		λ_d	λ_p		Min.	Typ.		Typ.	Max.
VT 6668	Yellow 	589	591	Clear	3550	4950	80	2.5	2.9

Absolute Maximum Ratings (at Ta=25°C)

P _D (mW)	I _{PF} (mA)	I _F (mA)	T _{sol} (°C)	I _R (uA)@V _R =5V	T _{opr} (°C)	T _{stg} (°C)
220	160	70	260 ± 5 for 5 sec	10	-40~+85	-40~+100

Note: Please take note the Absolute Maximum Rating values. Any operation beyond the specified ratings in this table will result degradation of LED life-span and may cause LED to fail.

* I_{FP}: Peak Forward Current under 1/10 duty, 1KHz condition

Package Dimension:

unit:mm

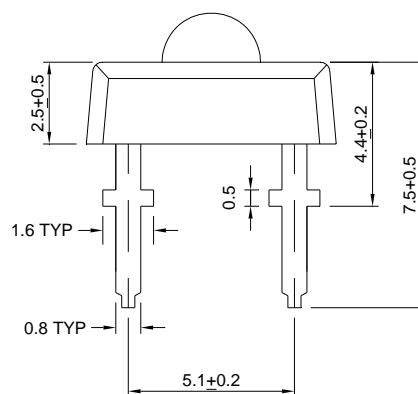
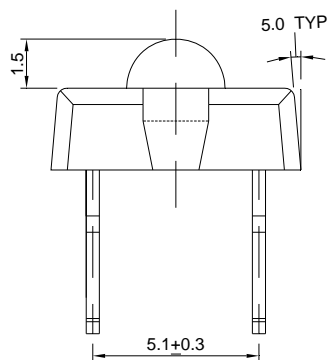
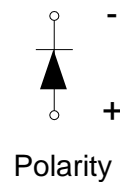
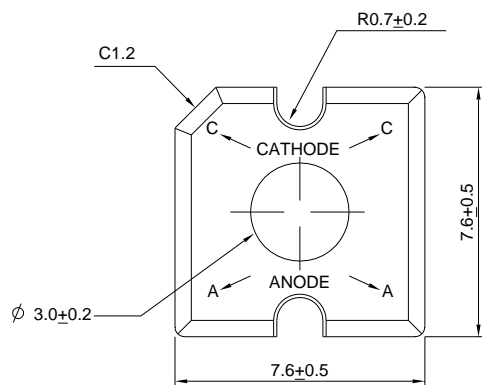

Notes:

1. All dimensions are millimeters.
2. Dimensional tolerance is ± 0.2 mm unless otherwise specified.
3. Specifications are subject to change without notice.