

## PLCC 6 Package SMD LED

### Description

The constructive of this series of LEDs are different from the PCB type SMT LED. The lead-frame is of metal, reflector is made of thermoplastic and construct into this unique type of SMD LED. The Wavelengths and Luminous Intensities of this series are grouped under 60mA for uniformity.

### VR K7A85

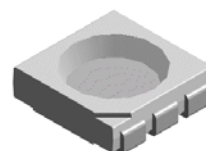

### Applications

- Dashboards and switch
- Backlight keypads
- Industrial control systems signal indicator
- Automotive features
- Telephone and fax backlighting or indicator

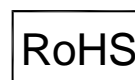

### Electronic Optical Characteristics (at 20mA per chip condition):

Part Number	Emitted Color	$\lambda$ (nm)		Lens Color	Iv(mcd)		View Angle (2 $\theta$ 1/2)	VF(V)	
		$\lambda_d$	$\lambda_p$		Min.	Max.		Typ.	Max.
VR K7A85	Red 	625	615	Clear	2300	2800	120	2.2	2.4

### Absolute Maximum Ratings (at Ta=25°C)

P <sub>D</sub> (mW)	I <sub>FP</sub> (mA)	I <sub>F</sub> (mA)	Soldering Temp.(°C)	I <sub>R</sub> (uA)@V <sub>R</sub> =5V	T <sub>opr</sub> (°C)	T <sub>stg</sub> (°C)
200	100*	60	260 ± 5 for 5 sec.	10	-40~+85	-40~+100

Note: Please take note the Absolute Maximum Rating values. Any operation beyond the specify ratings in this table will result degradation of LED life-span and may cause LED to fail.

\* I<sub>FP</sub>: Peak Forward Current under 1/10 duty, 1KHz condition

\* Above rating base on one dice condition

## Package Dimension:

unit:mm

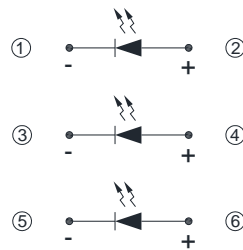

Polarity

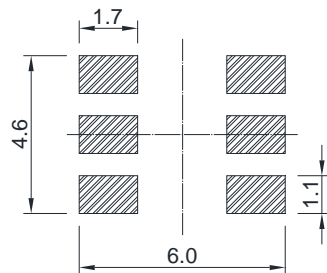
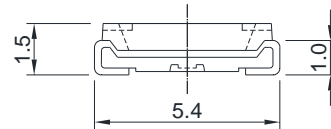
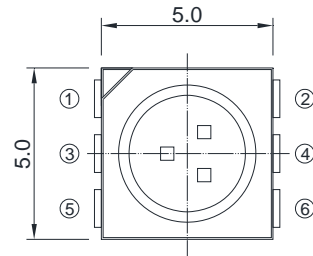

Recommended Soldering Pad

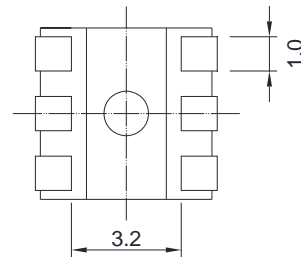

## Notes:

1. All dimensions are millimeters.
2. Tolerance is  $\pm 0.2\text{mm}$  unless otherwise specified.
3. Specifications are subject to change without notice.

## Optical Characteristics Curves

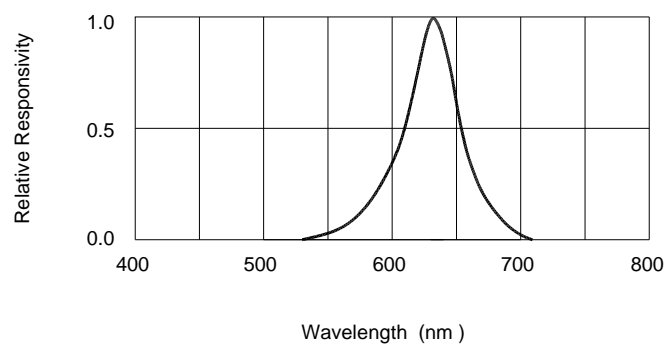
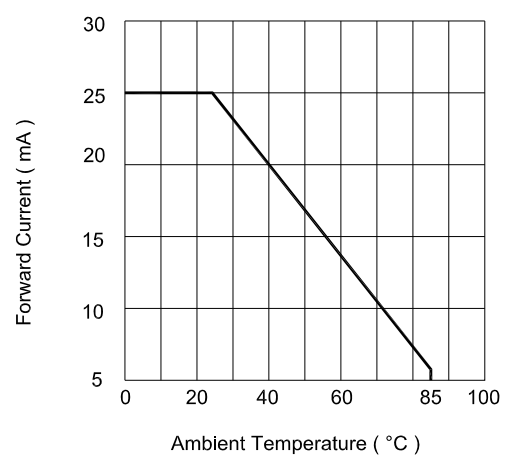
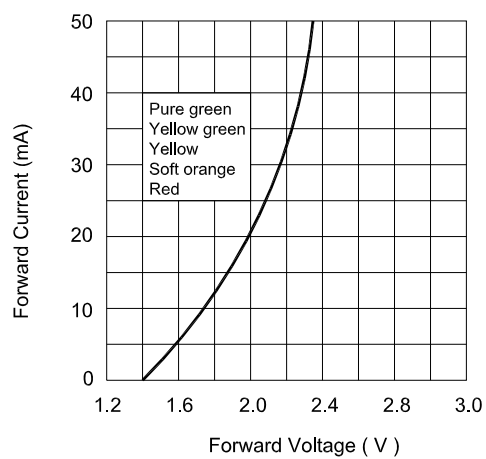
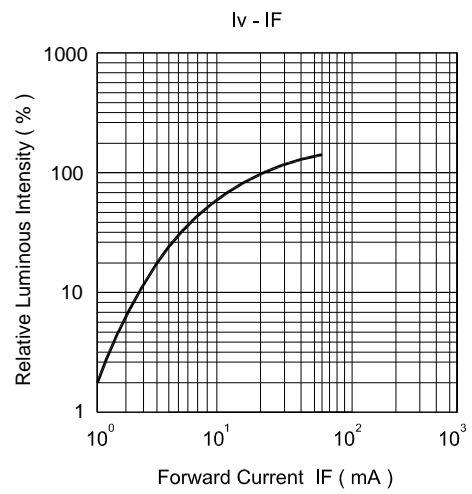
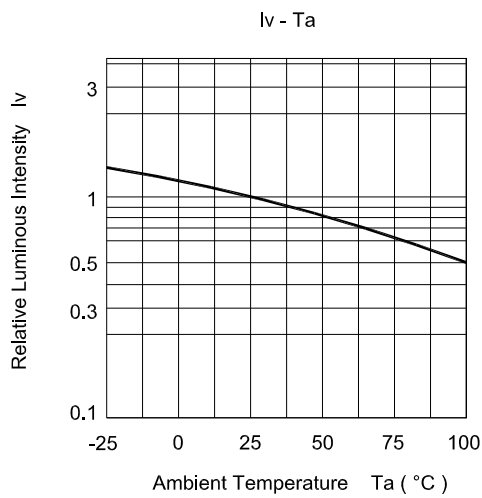



### Recommended re-flow soldering profile:

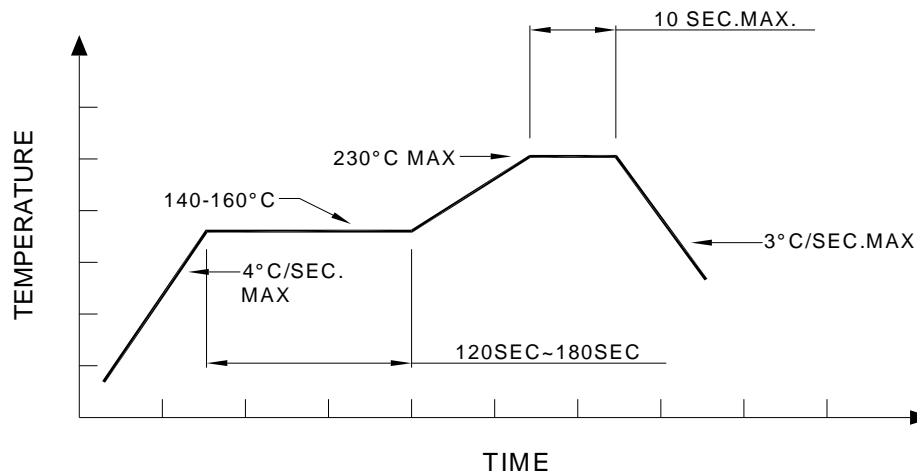

### Recommended Pb-free re-flow soldering profile:

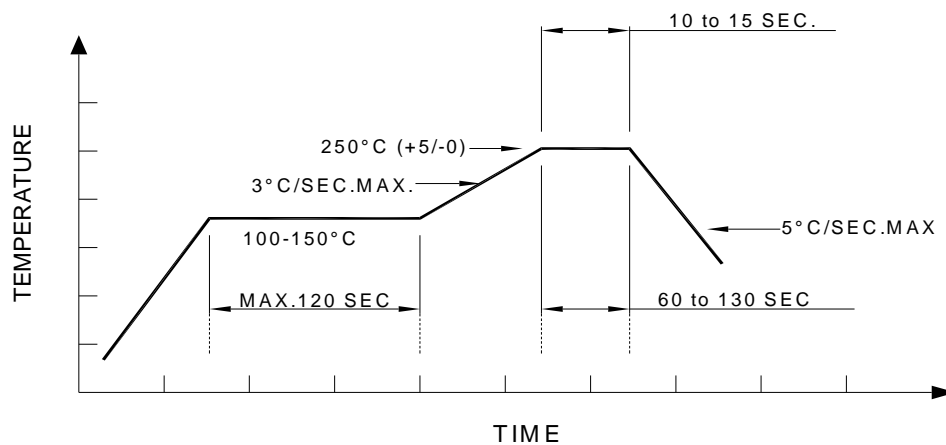

### Note:

All the specifications listed in this data sheet are suitable for general electronic equipment, office equipment and communication devices. Kindly consult Sales Representatives for specific reliabilities request, Forward Voltage, Luminous Intensity, Wavelength, Radiant Power or Viewing Angle.