

10mm Round Super Bright LED

VT 1A28

Description

This high brightness Bluish-green emitting LEDs are made from the most efficient InGaN technology. Its chip material is of InGaN technology, able to reach a high light output efficiency. These series of LEDs come in moisture resistance water clear lens while offering various viewing angles. Other than bulk packing, tape and reel is available. Changes in viewing angle, luminous intensity and lens color is acceptable.

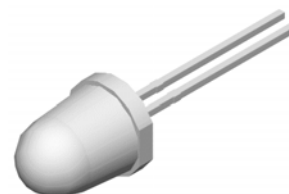

Applications

- Lighting indicator
- Status lights
- ON/OFF indicator
- Backlight illumination

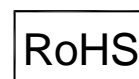

Electronic Optical Characteristics (at 20mA):

Part Number	Emitted Color	λ (nm)		Lens Color	Iv(mcd)		View Angle (2 θ 1/2)	VF(V)	
		λ_d	λ_p		Min.	Typ.		Typ.	Max.
VT 1A28	Bluish-green	505	502	Clear	3550	8050	10	3.5	3.8

Absolute Maximum Ratings (at Ta=25°C)

P _D (mW)	I _{FP} (mA)	I _F (mA)	T _{sol} (°C)	I _R (uA)@V _R =5V	T _{opr} (°C)	T _{stg} (°C)
90	100*	25	260 ± 5 for 5 sec.	50	-40~+85	-40~+100

Note: Please take note the Absolute Maximum Rating values. Any operation beyond the specify ratings in this table will result degradation of LED life-span and may cause LED to fail.

* I_{FP}: Peak Forward Current under 1/10 duty, 1KHz condition

Package Dimension:

unit: mm

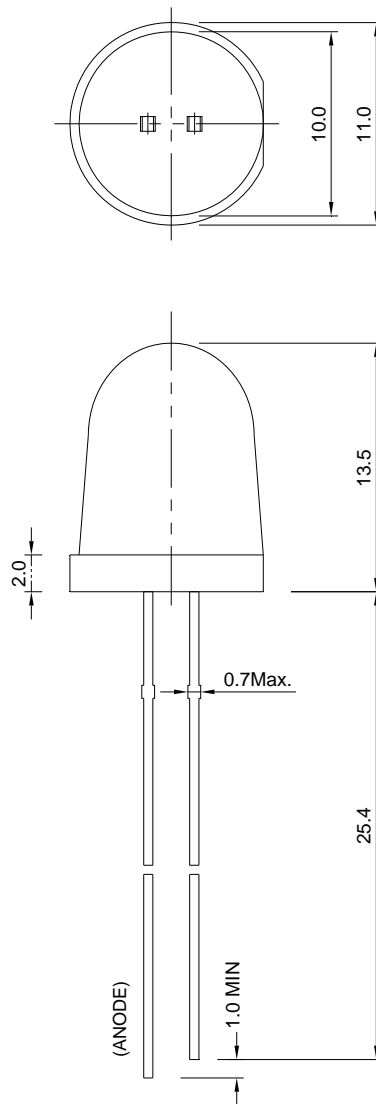

Notes:

1. All dimensions are millimeters.
2. Dimensional tolerance is ± 0.2 mm unless otherwise specified.
3. Epoxy meniscus under flange is 1.5 mm max.
4. Specifications are subject to change without notice.